

④ (Plan 1, 2, 3) N ←

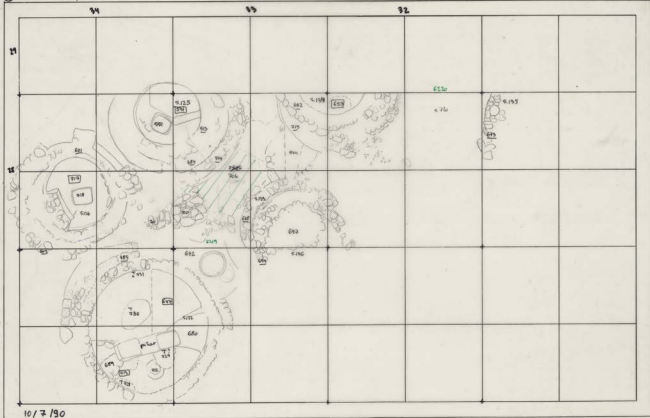

10/7/90

⑥

N ←

34

33

208.94 4.0-5

207.94

32

29

28

27



①

N ←

34

33

25.34.021 34.15

32

29

28

27

13/7/90

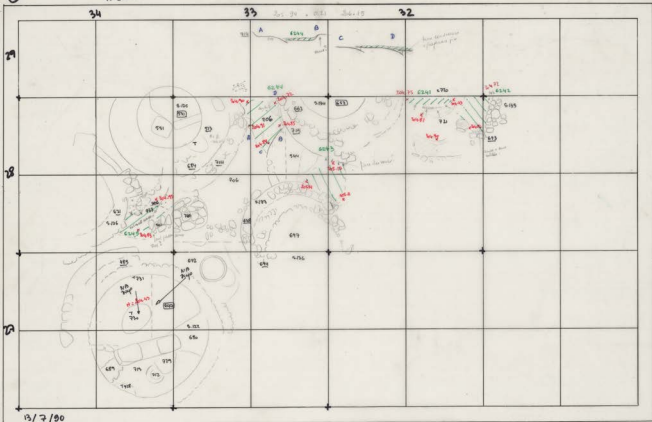

9

N ←

34

33

205.14 + 28 = 206.22 32

29

28

27

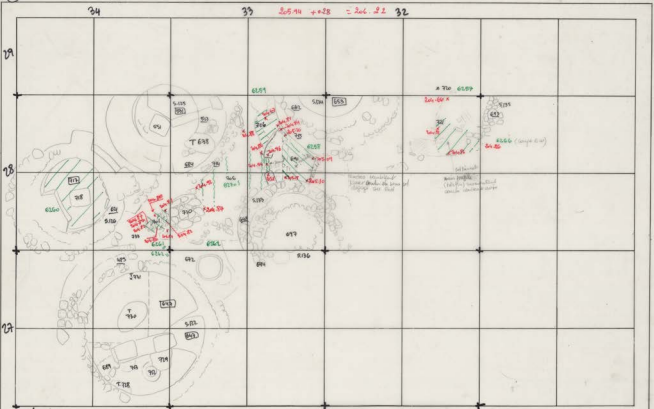

16/7/90

10

N ←

34

33

265.94 + 0.19 = 266.13

32

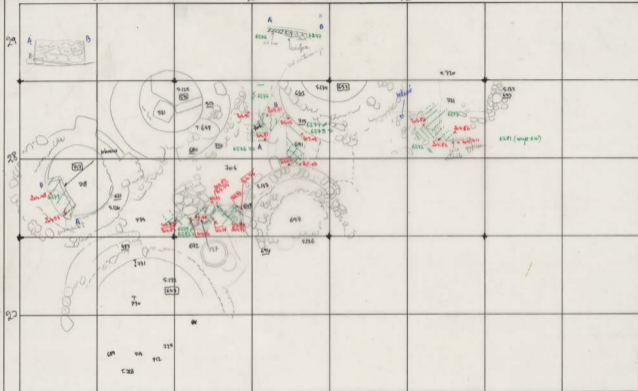

17/7/90

62.80 : di. mur de 50'
 62.85 : base de construction
 du mur.

= 773

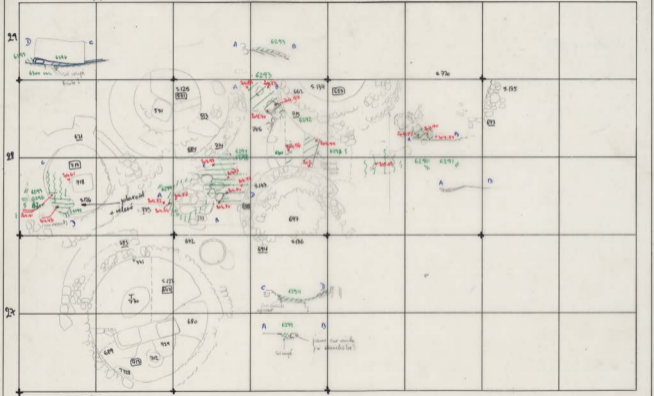

18/7/90

①

N ←

34

33

205,36 + 0,77 = 206,12.

32

24

23

22

19/7/90

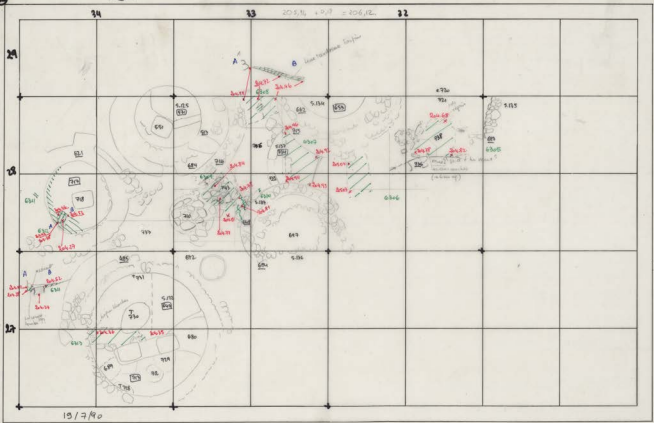

13

N ←

34

33

205,94 + 0,28 = 206,12

32

29

28

27

20 / 7 / 90

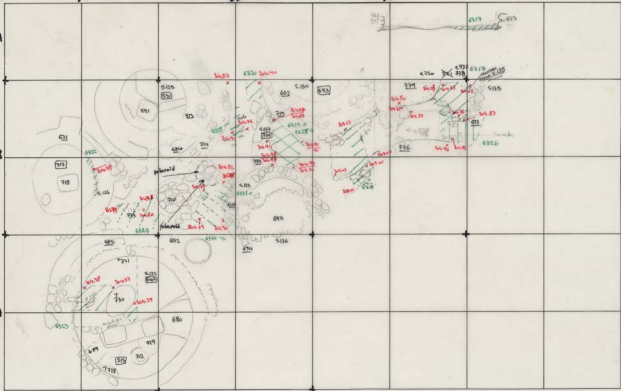

18

N

34

33

205,94 + 0,35 = 206,29

32

29

28

27

26 / 7 / 90

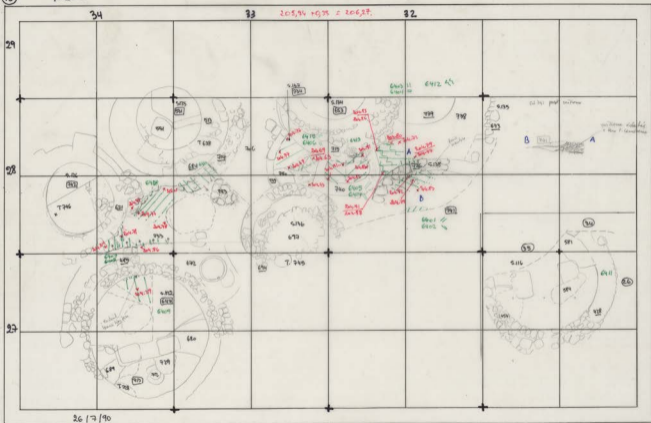

19

N ←

34

33

205,84 + 9,16 = 206,00

32

34

33

32



27/7/90

21 N ←

34

33

205,54 + 0,20 = 206,14.

32

29

28

27

30/7/90

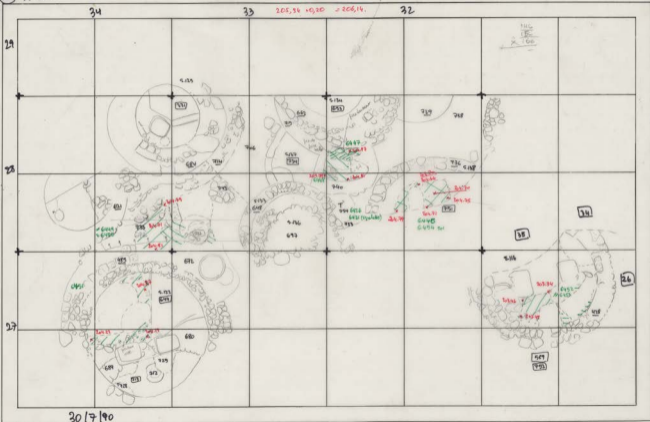

23 No

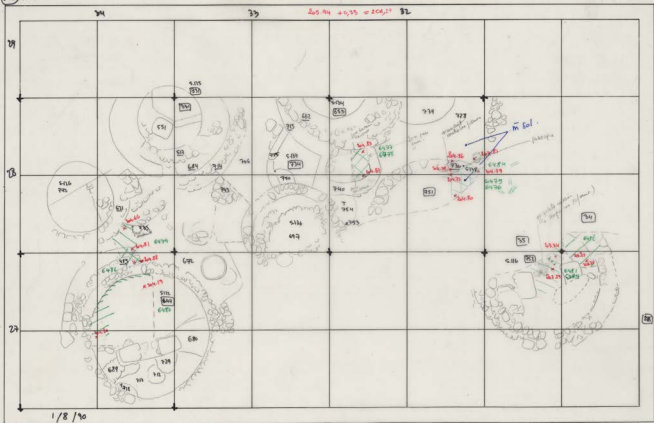

26 N ←

34

33

206 911 4070 = 206,24. 32

28

27

26



3/8/40

34

33

205,94 x 0,50 = 206,84 32



6/8/90





31 NW

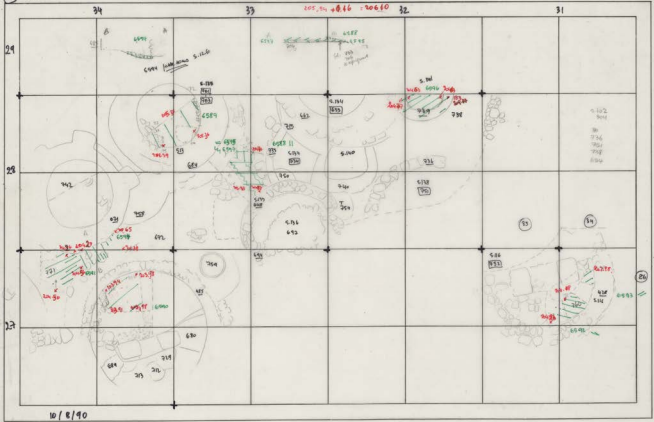

10/8/90

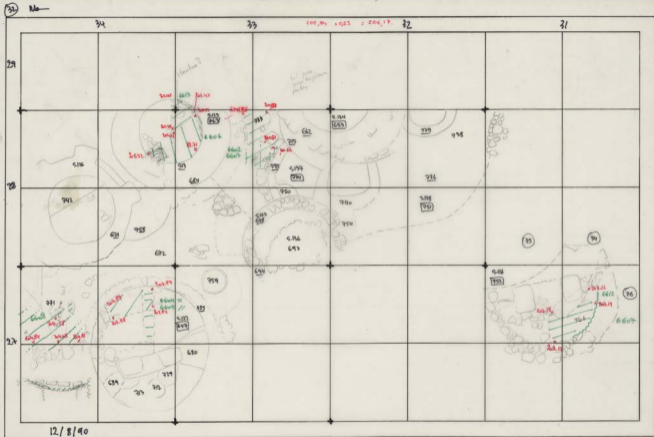

12/8/40

59

N₆

34

35

207,94 = 424 = 206,18 22

29

18

23



13/8/90

34 N ←

34

33

$209,34 + 0,28 = 209,62$

32

29

28

27

26

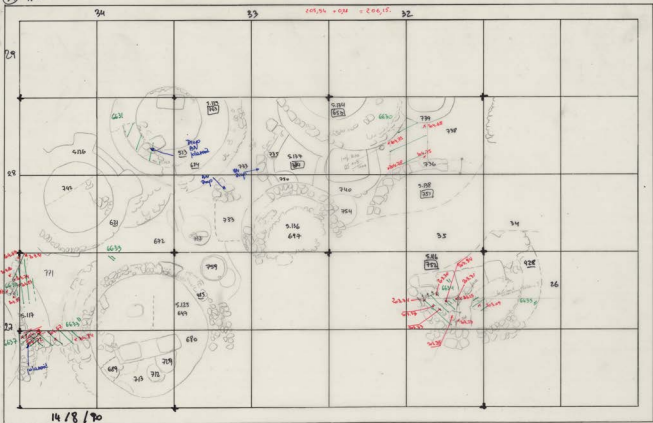

14/8/90

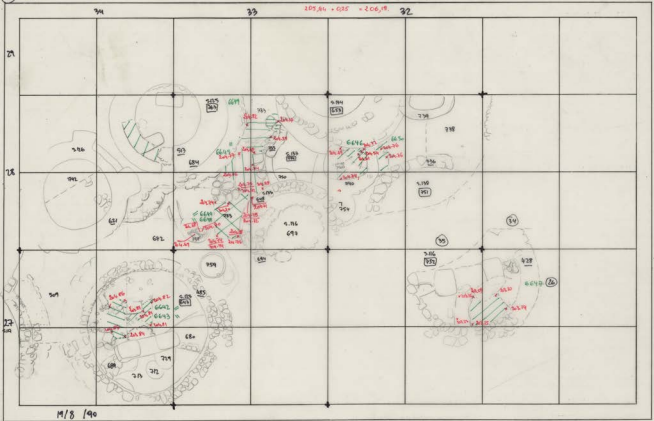

M/B 190

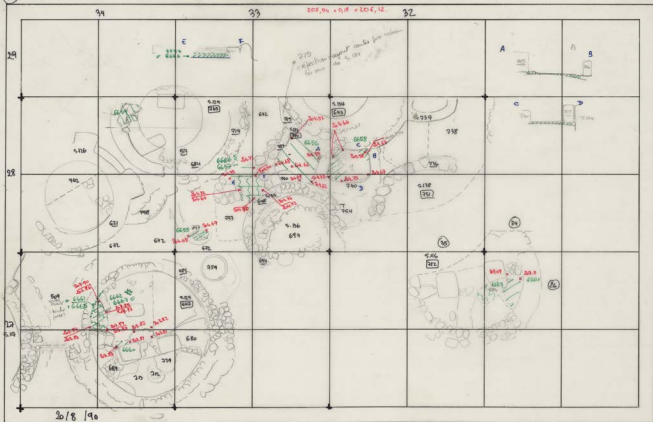

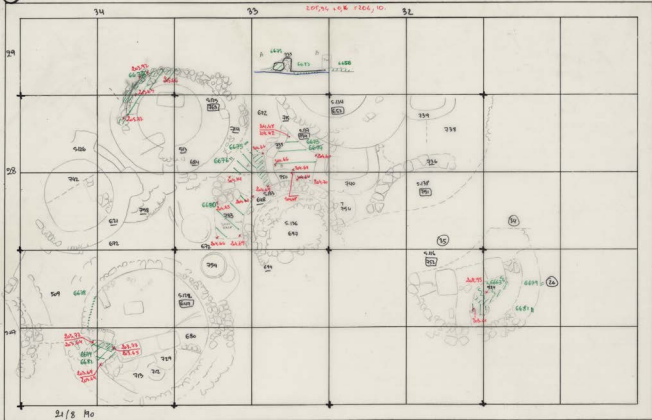

30 N ←

34

33

205,74 ± 0,12 = 106,06

32

29

28

27

22/8 Mo

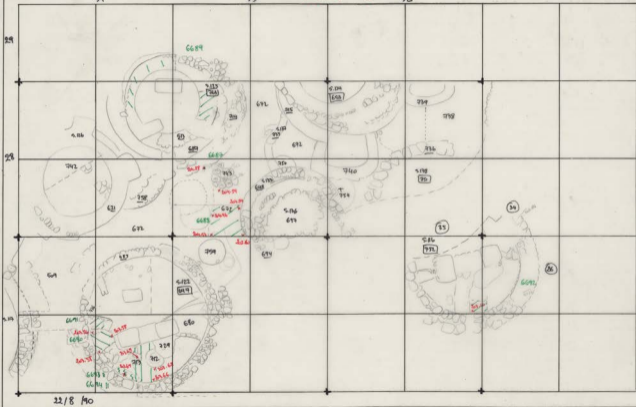

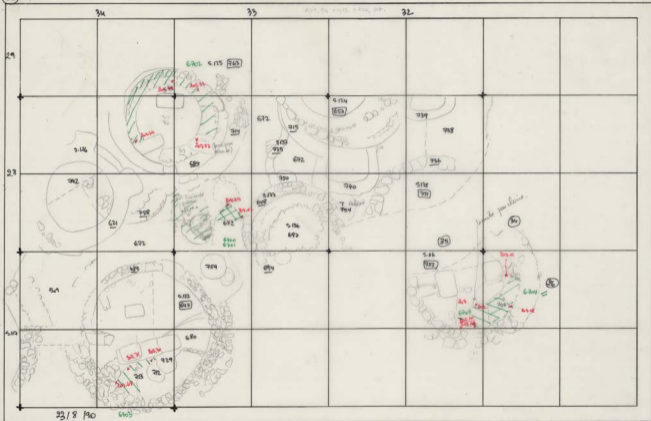

34

33

205,54 + 0,10 = 205,64

32

29

28

27

24/8/90

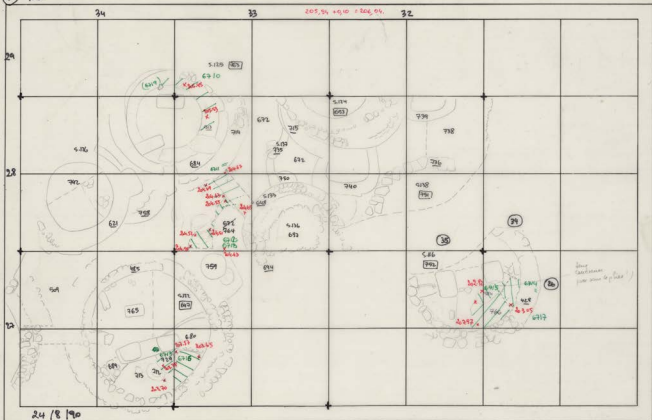

(21) No-

34

33

205, 84 x 90 = 204, 00'

32

27

28

29

26/8/90

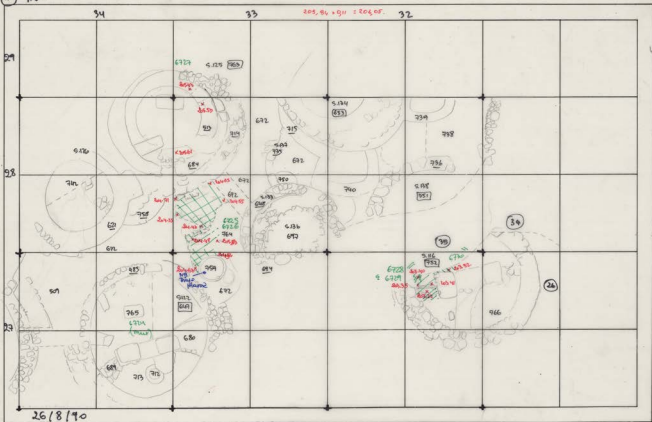

34

33

205,84 + 96 = 206.

32

29

28

27

27/8/90

